



MAYA  
KA'AN

DONDE LA TIERRA LATE



aldea  
sukum



aldea  
sukum



## Federal Protected Natural Areas of Mexico

Áreas Naturales Protegidas Federales de México. Noviembre 2017

Catálogo de metadatos geográficos. Comisión Nacional para el Conocimiento y Uso de la Biodiversidad

Autor: SEMARNAT-CONANP, (01/11/2017)

Palabras clave: ANP, Áreas, Biosfera, Categoría, Manejo, Decreto, Flora, Fauna, Monumento, Nacional, Naturales, Protegidas, Recursos, Reserva, Santuarios, Parque

Fecha de publicación: 06-12-2017, del metadato 06-12-2017

Descargas: [Google Earth \(KML\)](#), [ESRI Shapefile \(SHP\)](#), [Metadatos](#)

Accesos directos: [Vista previa](#), [Geoportal CONABIO](#), [Metadato \(HTML\)](#).



aldea  
sukum



Reserva de la Biosfera Sian Ka'an



aldea sukum

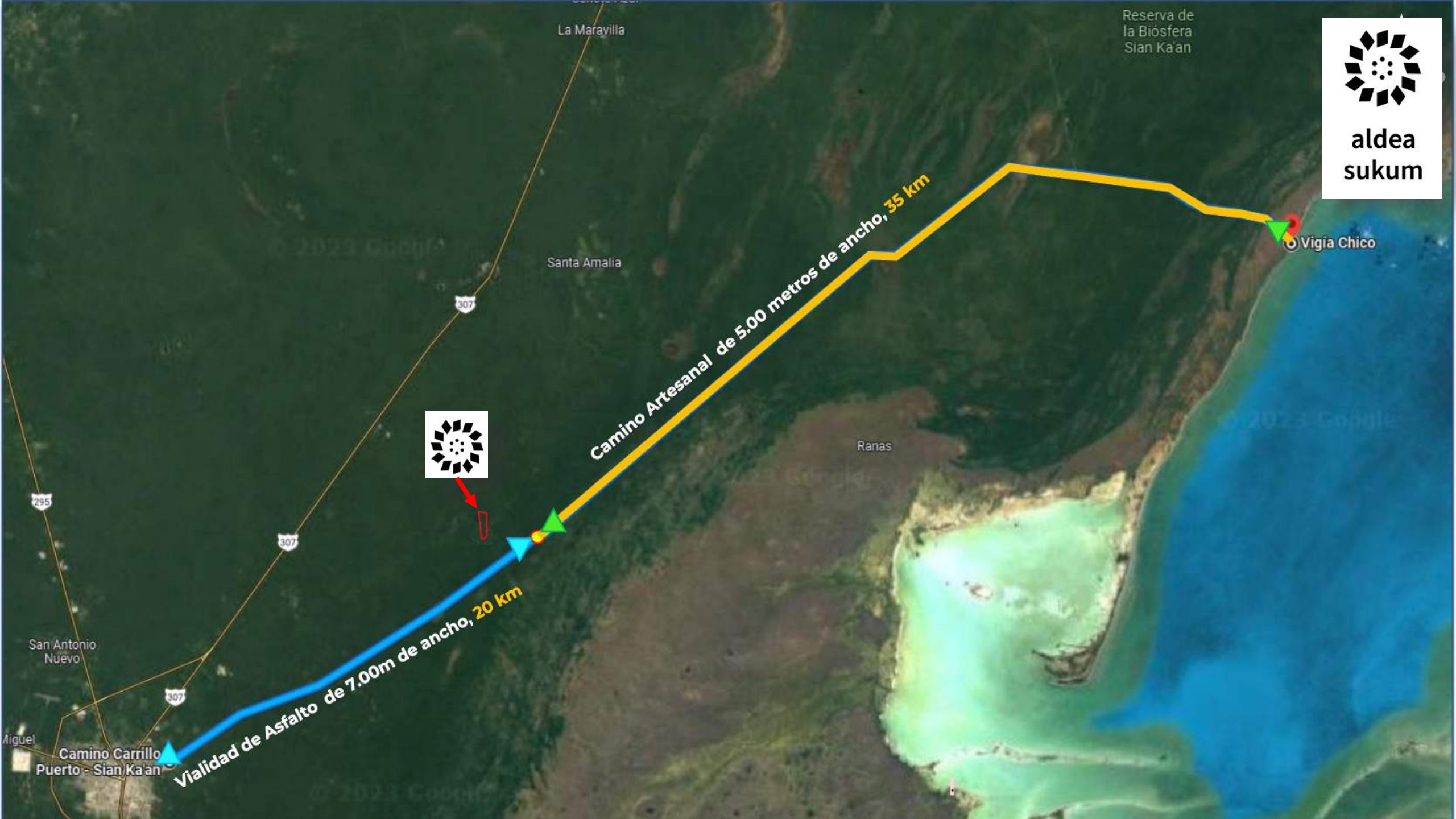

La Maravilla

Santa Amalia

Ranas

Vigia Chico

295

307

San Antonio Nuevo

307

Aiguel

Camino Carrillo Puerto - Sian Ka'an

Vialidad de Asfalto de 7.00m de ancho, 20 km

Camino Artesanal de 5.00 metros de ancho, 35 km



307

© 2023 Google

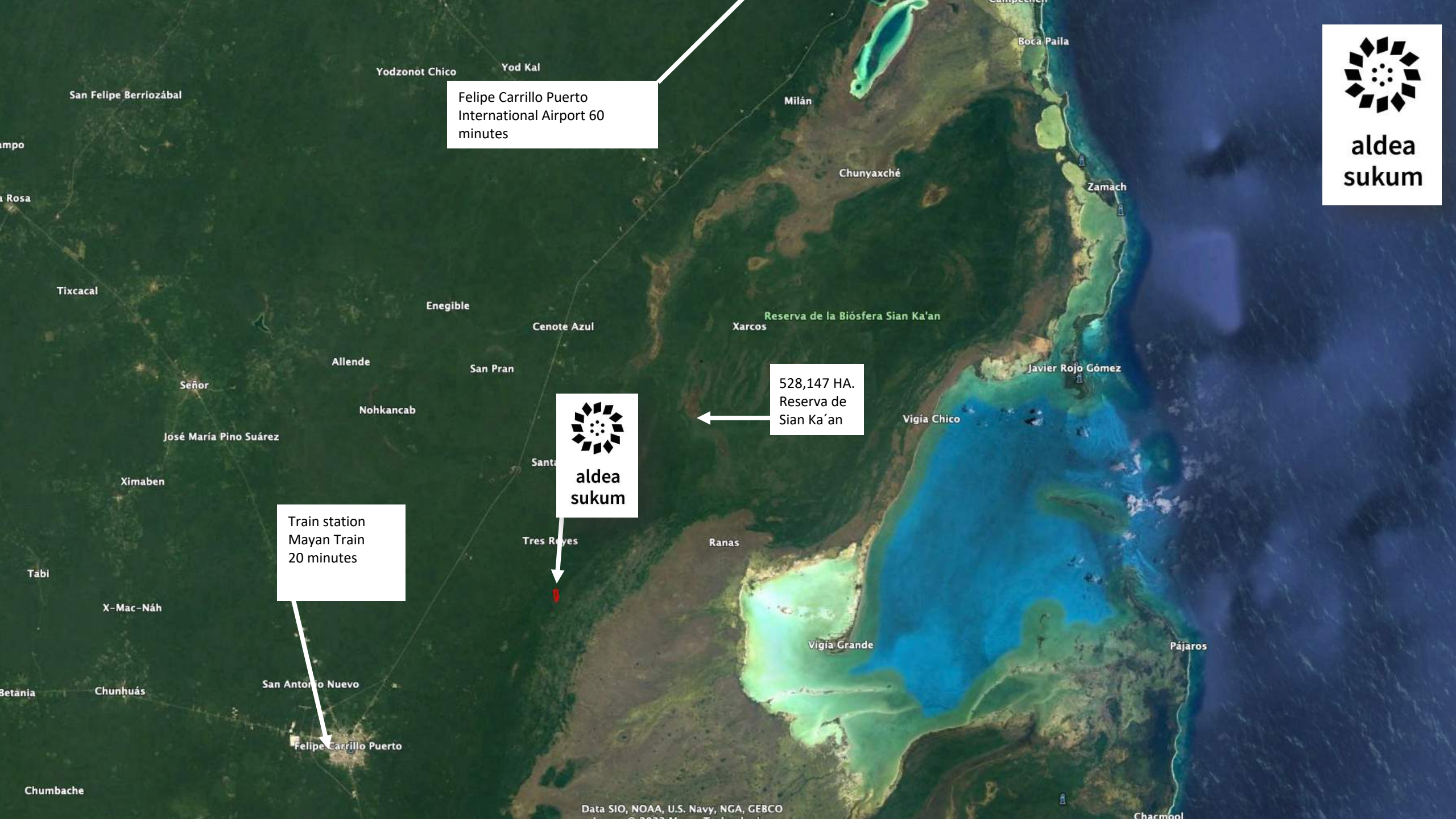

Felipe Carrillo Puerto  
International Airport 60  
minutes

528,147 HA.  
Reserva de  
Sian Ka'an



Train station  
Mayan Train  
20 minutes

# Inspiration and Purpose

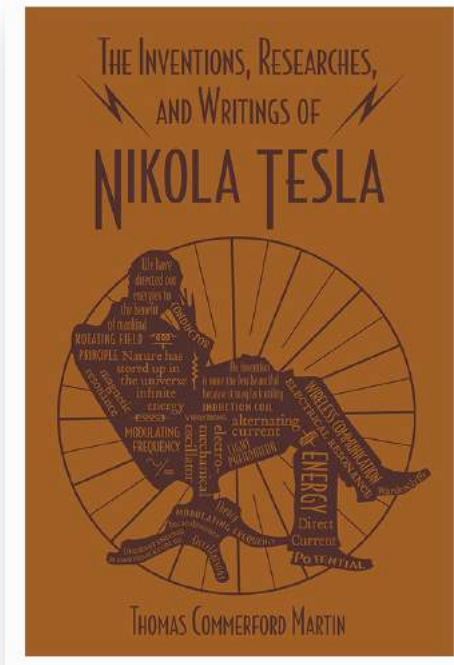

“When we look at the world around us, at Nature, we are impressed by its beauty and grandeur. “the soul itself is shown in the eyes.”

Excerpt from: Thomas Commerford Martin. "The inventions, research, and writings of Nikola Tesla." Apple Books.

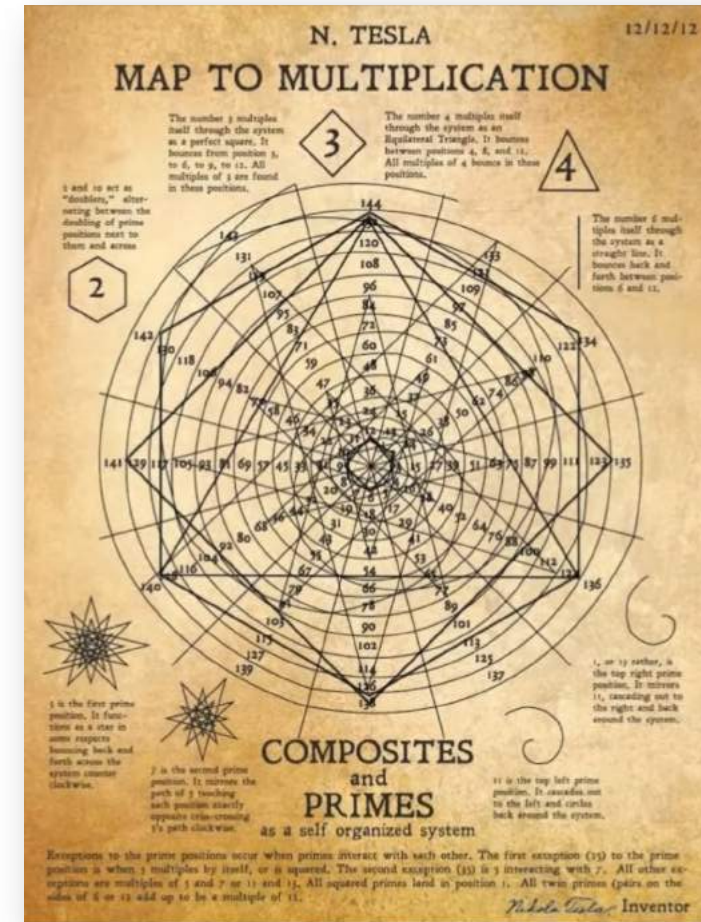

“If you knew the magnificence of the numbers three, six and nine, you would have a key to the universe.” Nikola Tesla, author of this Mathematical Spiral:

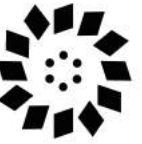

aldea  
sukum

In addition to Tesla's knowledge, we will also take the Golden Ratio Fibonacci series

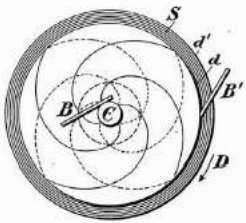
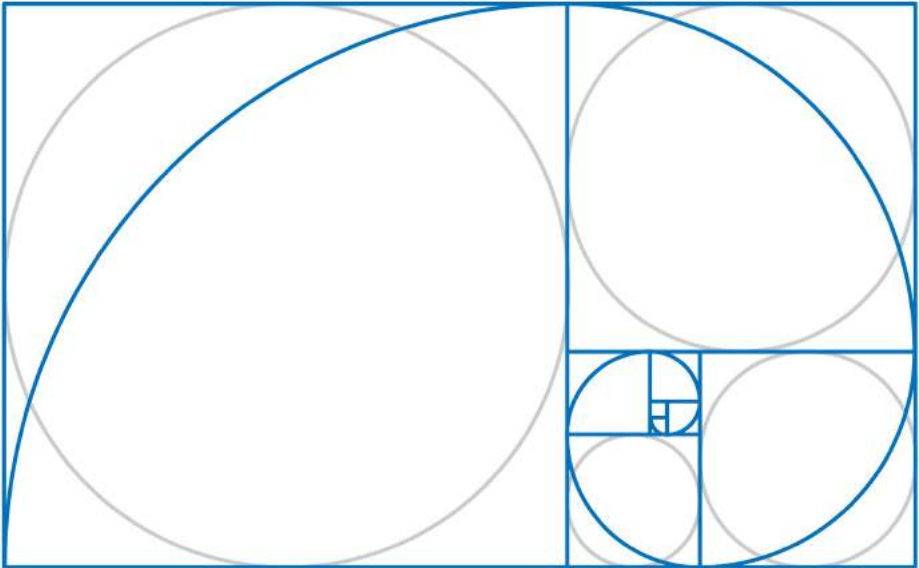

FIG. 295.

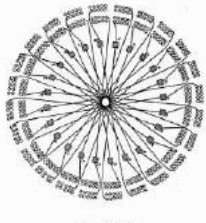

FIG. 277.

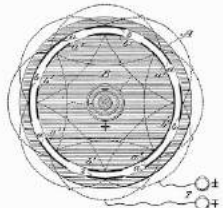
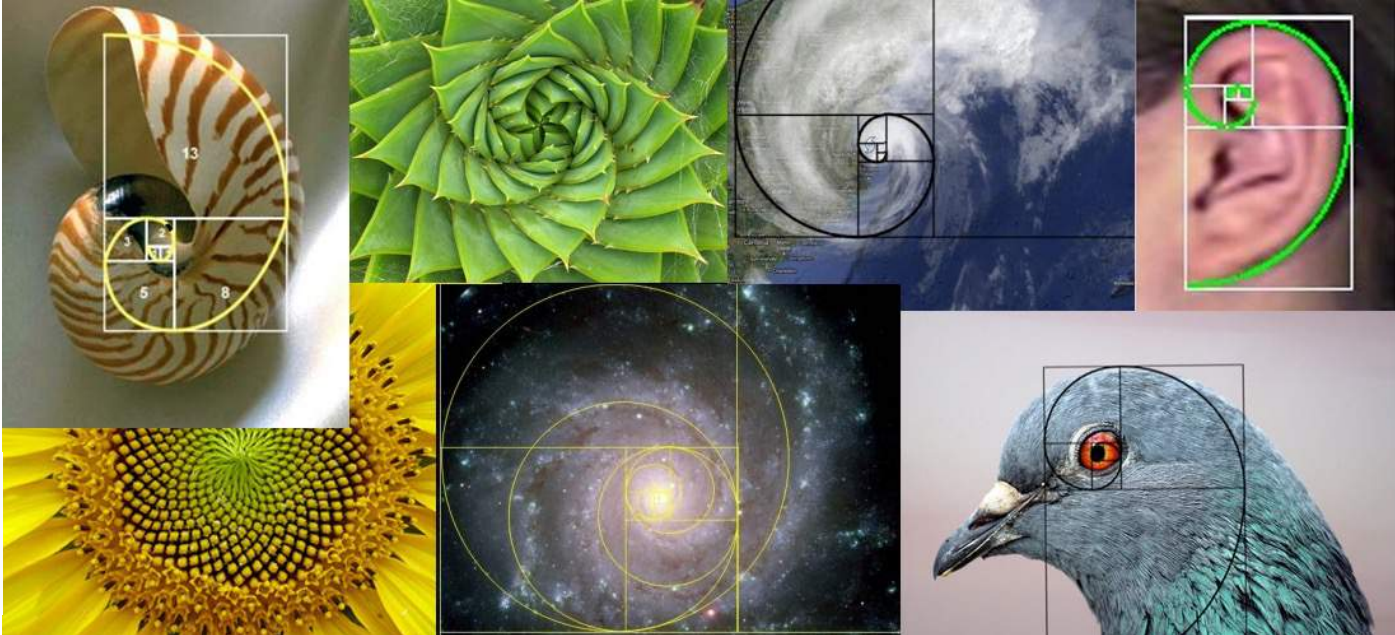

FIG. 208.



IMPROVEMENT IN "UNIPOLAR" GENERATORS



# Art design and cosmic synchrony from urbanization



aldea  
sukum

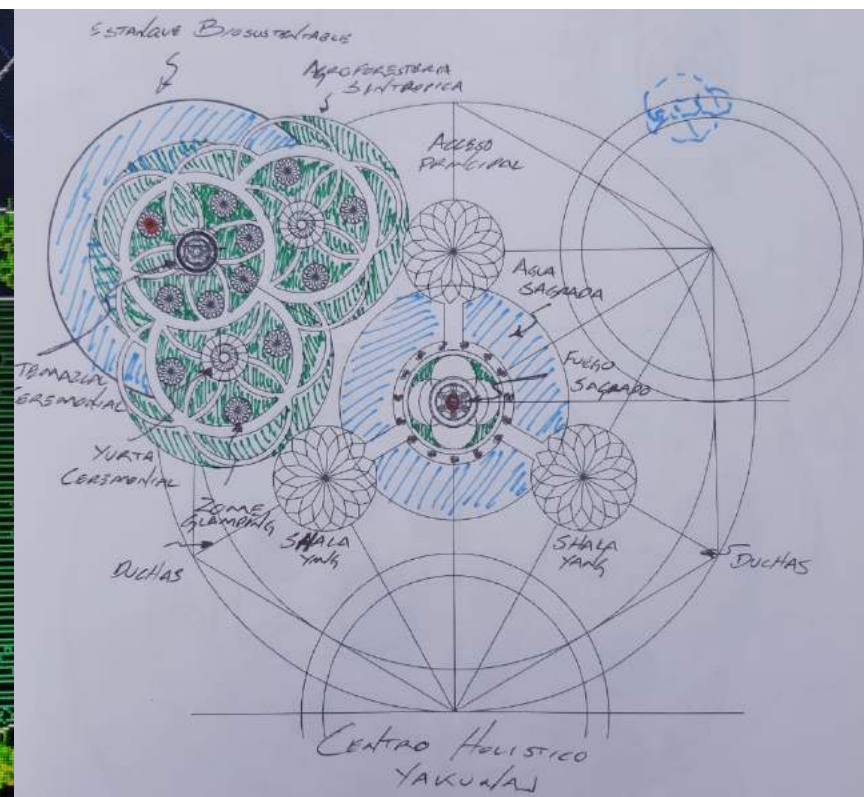



aldea  
sukum

MASTER PLAN of 27 HA, of which more than 60% of green areas of 15 to 16 HA green

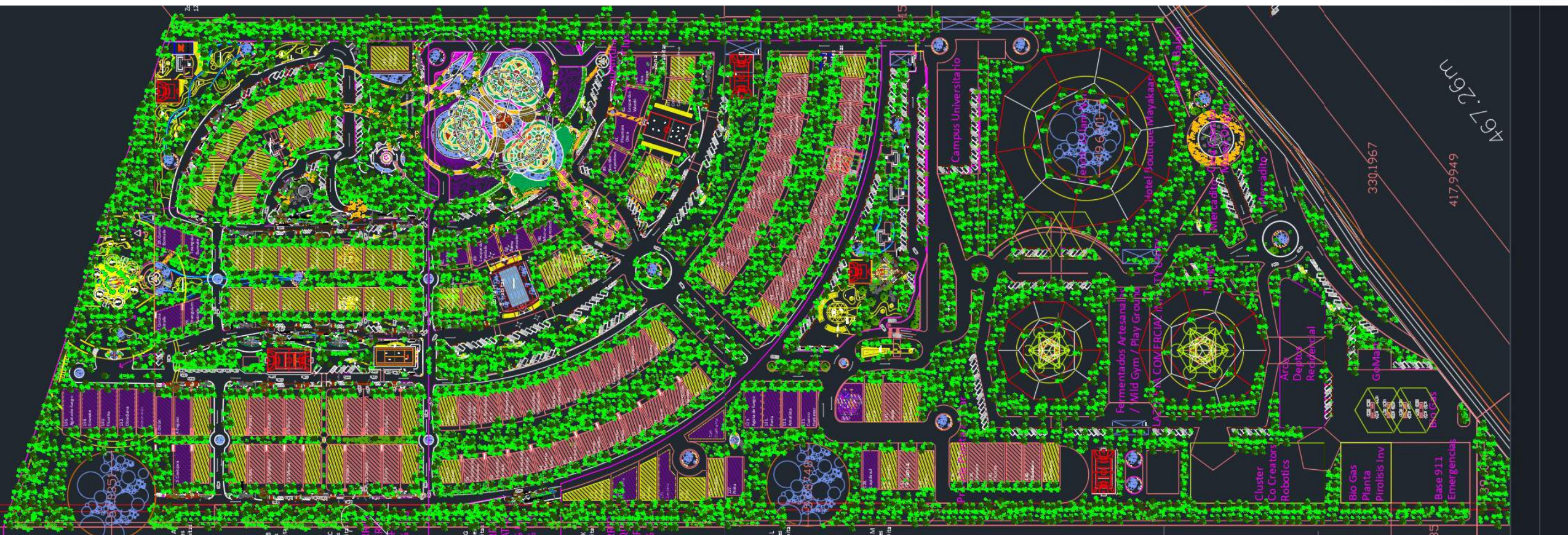

# MASTER PLAN

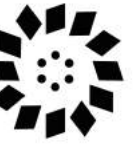

aldea  
sukum

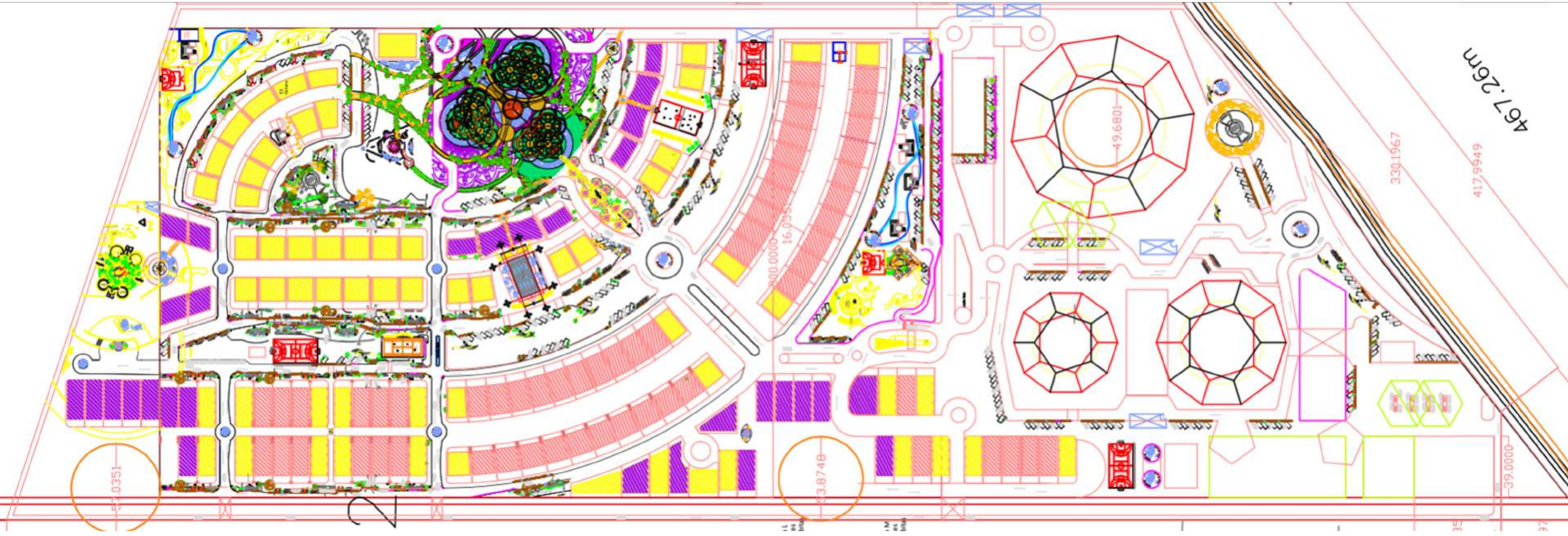

# Green Infrastructure Implementation Reference



aldea  
sukum



# Green Infrastructure Implementation Project

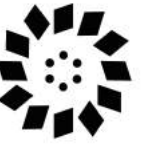

aldea  
sukum

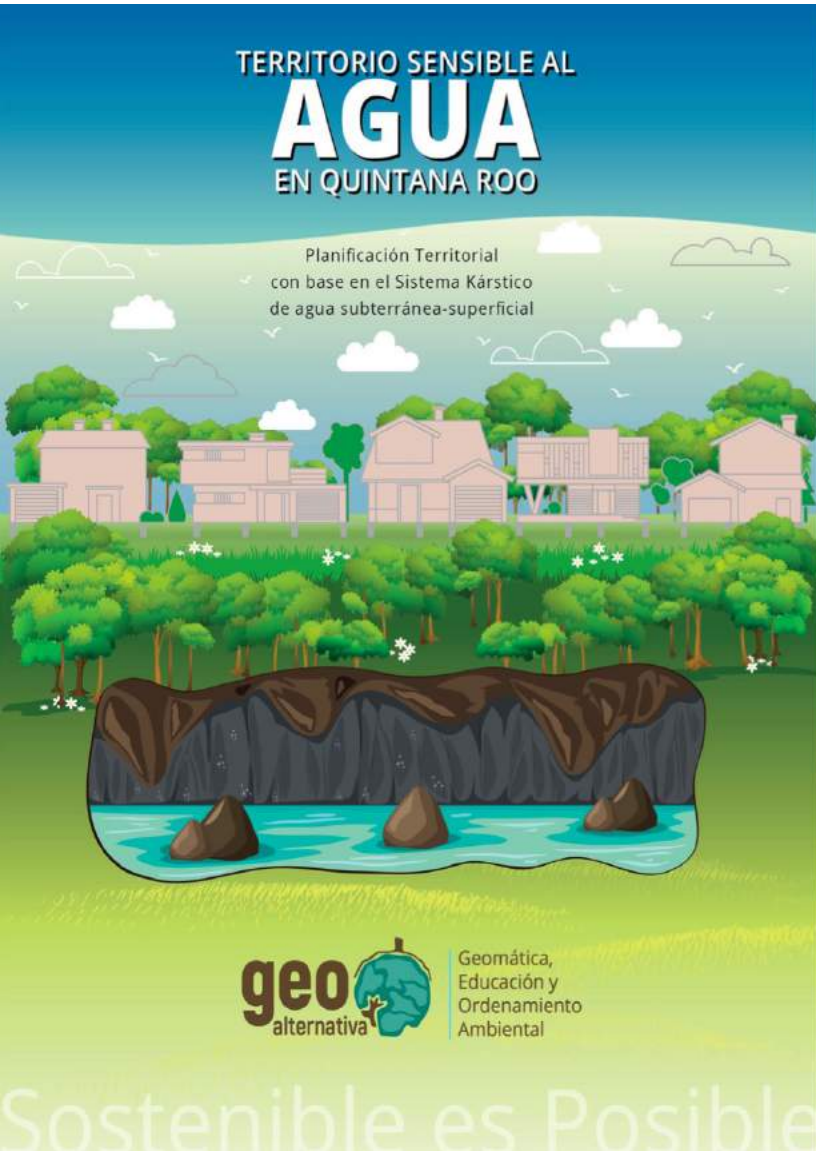

**SEDETUS**  
SECRETARÍA DE DESARROLLO  
TERRITORIAL URBANO SUSTENTABLE

**SEMA**  
SECRETARÍA DE ECOLOGÍA  
Y MEDIO AMBIENTE

Con la visión y el apoyo del gobierno del estado de Quintana Roo, a través de la Secretaría de Desarrollo Territorial Urbano Sustentable y la Secretaría de Ecología y Medio Ambiente, así como la Red Mexicana de Cuencas y la Red Latinoamericana en el Rescate de Ríos Urbanos e investigadores de El Colegio de la Frontera Sur.

Con el visto bueno del gremio de cuencas a través de:



RED  
Latinoamericana en el  
Rescate de Ríos Urbanos

## AUTORÍA

### Planificación territorial base vocación natural del sistema hidrológico

M. en Cs. Silvana Marisa Ibarra Madrigal

### Diseño en ingeniería civil, modelación hidrodinámica

M.C. David Gustavo Rejón Parra  
Ing. Yesenia Nayrovick Hernández Montero  
Ing. Javier Rodrigo Nahuat Sansores  
Ing. Miguel Ángel Sánchez Quijano

### Valoración económica.

M.E.S.P. Roberto Mena Rivero

### Gestor Cultural, Ciudadanía & Sostenibilidad.

Arq. Ángel Iván Romero Martínez



Figura 20 Gráfico de los pavimentos porosos Fuente: Obtenido de: (Instituto Municipal de Planeación Urbana de Hermosillo, 2018)

Sostenible es Posible

# Green Master Plan

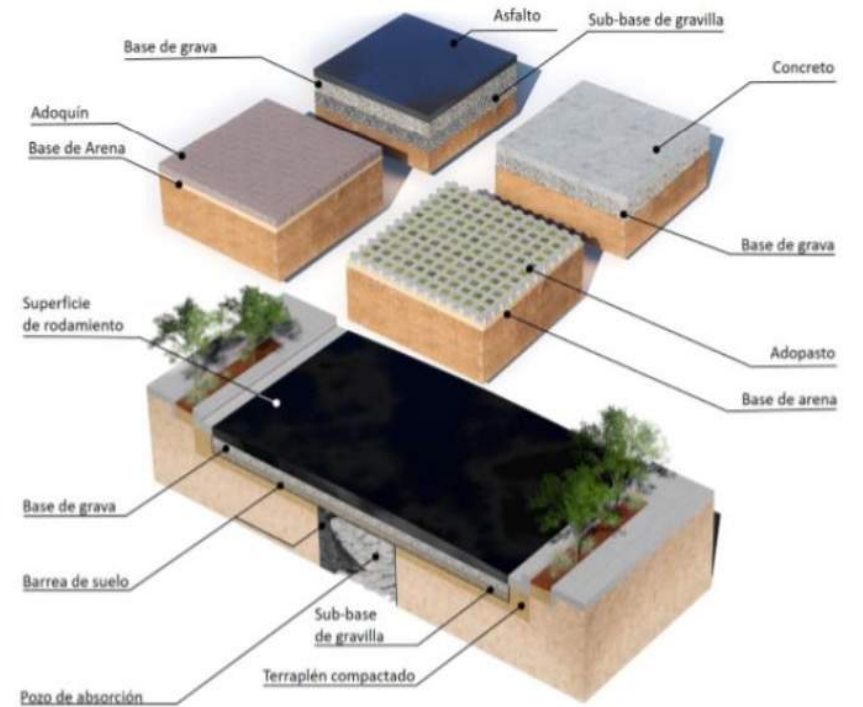
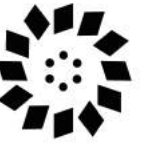

aldea  
sukum

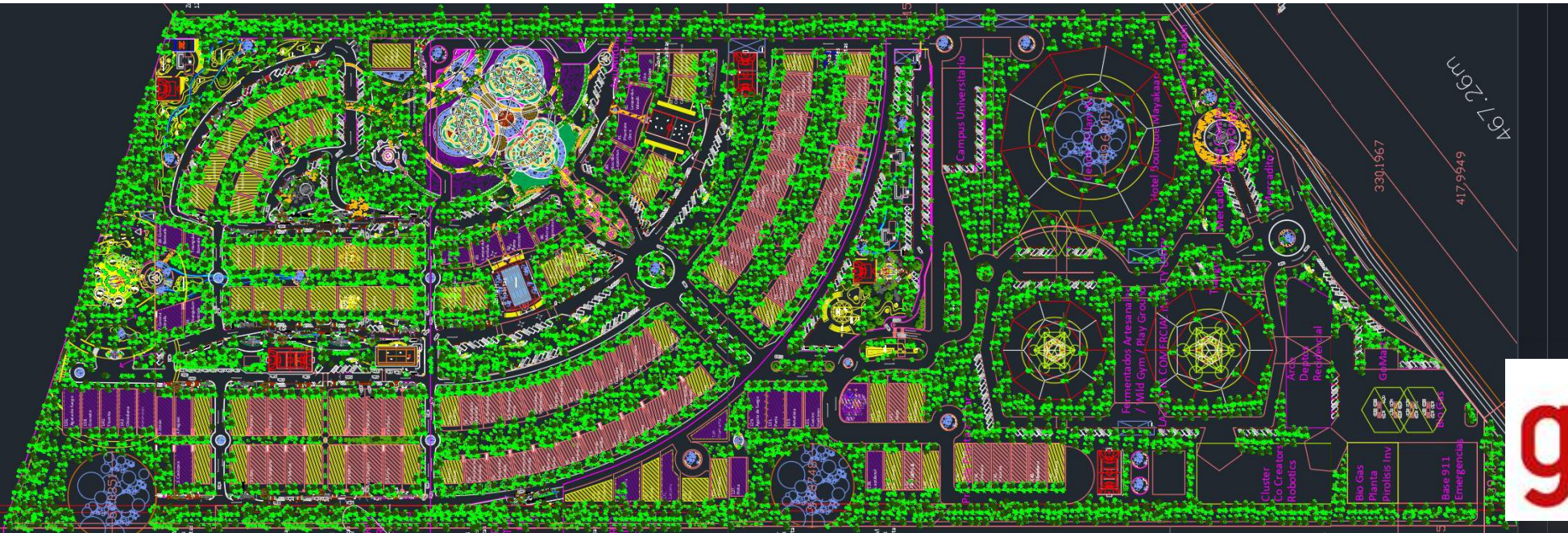





aldea  
sukum



Wildlife  
passages to the  
internal  
corridors and to  
the outside

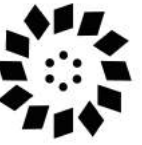

aldea  
sukum

Inspiration and Purpose: Meets the standards of the SDG 2030 agenda,  
And from the German GIZ Fund.



aldea  
sukum

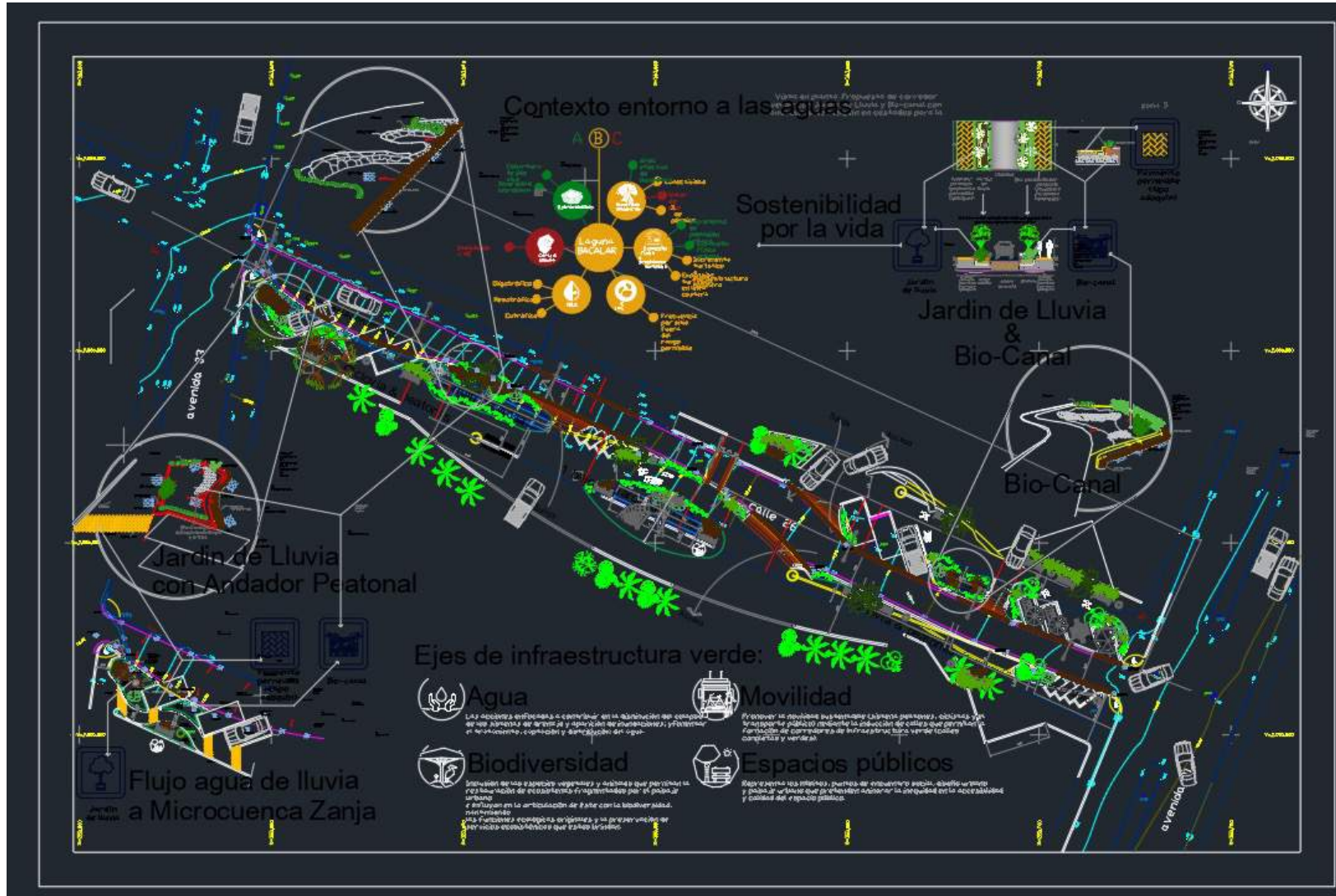

# Perspective of the Peace Lighthouse and Science School.



aldea  
sukum

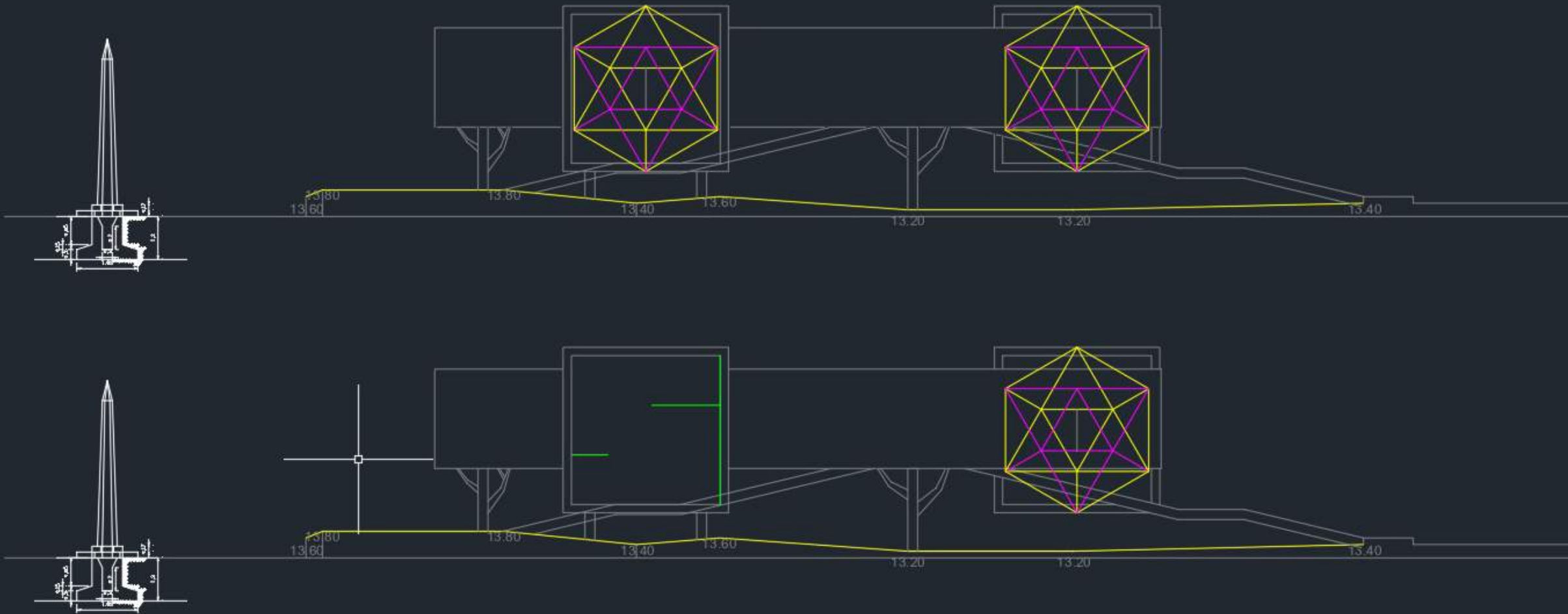

Target Market: LOHAS / Leaders in Costa Rica

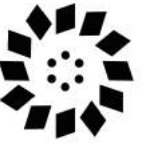

aldea  
sukum

**“Healthy and sustainable lifestyle”  
(Lifestyles of Health and Sustainability).**

How big is the LOHAS market?

The Total Addressable Market (TAM) for Lifestyle Health and Sustainability (LOHAS) in the United States was 355 billion dollars in 2019, up from \$290 billion in 2008. The market is expected to grow 10% annually.

May 21, 2022



# Market references:

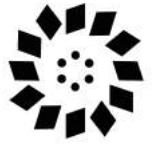

aldea  
sukum

**F** Forbes México  
<https://www.forbes.com.mx/ad-a...>

## AZULIK anuncia su icónico proyecto residencial en Tulum

Dec 27, 2022 — ... AZULIK Residences, el primer proyecto residencial de AZULIK. La iniciativa ... **Forbes Life** · Te contamos todo del próximo Tulum Crypto Fest, el ...



**F** Forbes  
<https://www.forbes.com/jimdobson/2023/07/27/>

## Futuristic AZULIK Resort Will Open In AIUla, With ... - Forbes

Jul 27, 2023 — Flights into AIUla are now more available than ever before via Dubai, Cairo, or Paris. Numerous resorts are now open, including the stunning ...



## Architectural References:

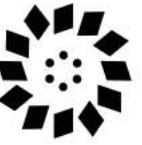

aldea  
sukum

Architectural  
References: ASTRAL  
DISTRICT (BARRIO  
ASTRAL)

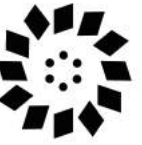

aldea  
sukum

Organic  
Architecture  
Housing Barrio  
Astral in  
ferrocement like  
the Akalki fairy

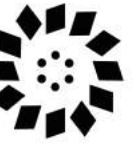

aldea  
sukum



Architectural  
References:  
AVATAR  
NEIGHBORHOOD  
(BARRIO AVATAR)

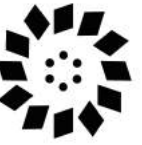

aldea  
sukum

# Architectural References: ALQUIMIA NEIGHBORHOOD (BARRIO ALQUIMIA)

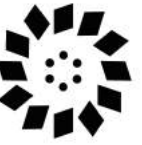

aldea  
sukum



Architectural  
References of  
the Almeja  
Residence

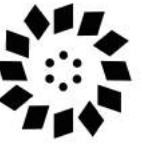

aldea  
sukum

Architectural References of the Origin Temple



Central palapa  
Museo Origen,  
cosmic house, in  
front of the road  
next to Mercadito  
and Aldea Ek  
Balam



Art in home  
details



aldea  
sukum

# Architectural References: Exteriors

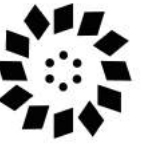

aldea  
sukum

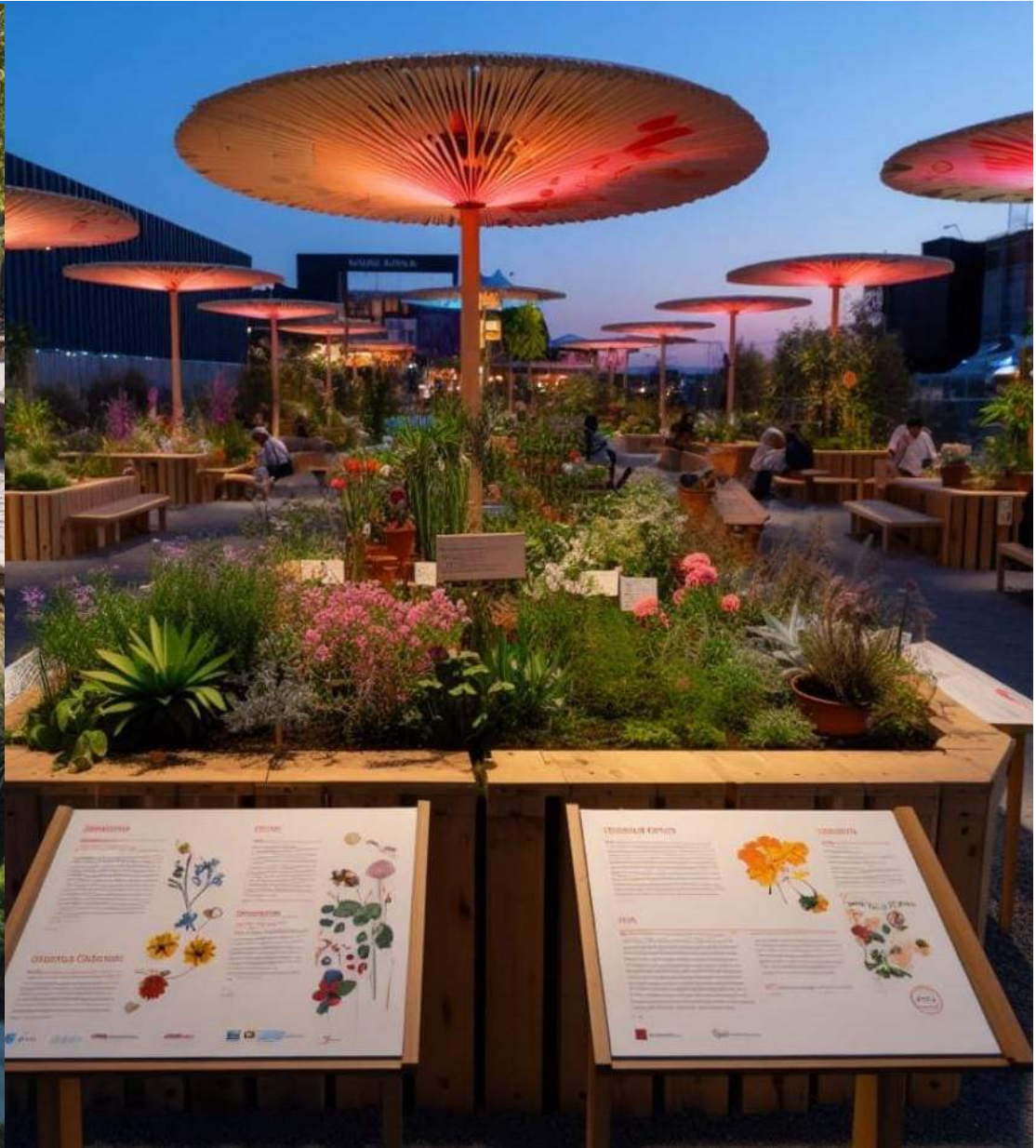

Architectural  
References:  
Render Hotel  
Boutique  
next to cenote

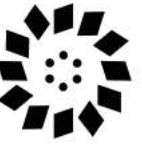

aldea  
sukum